

Smart Baby Camera Wifi Setup

Step 1

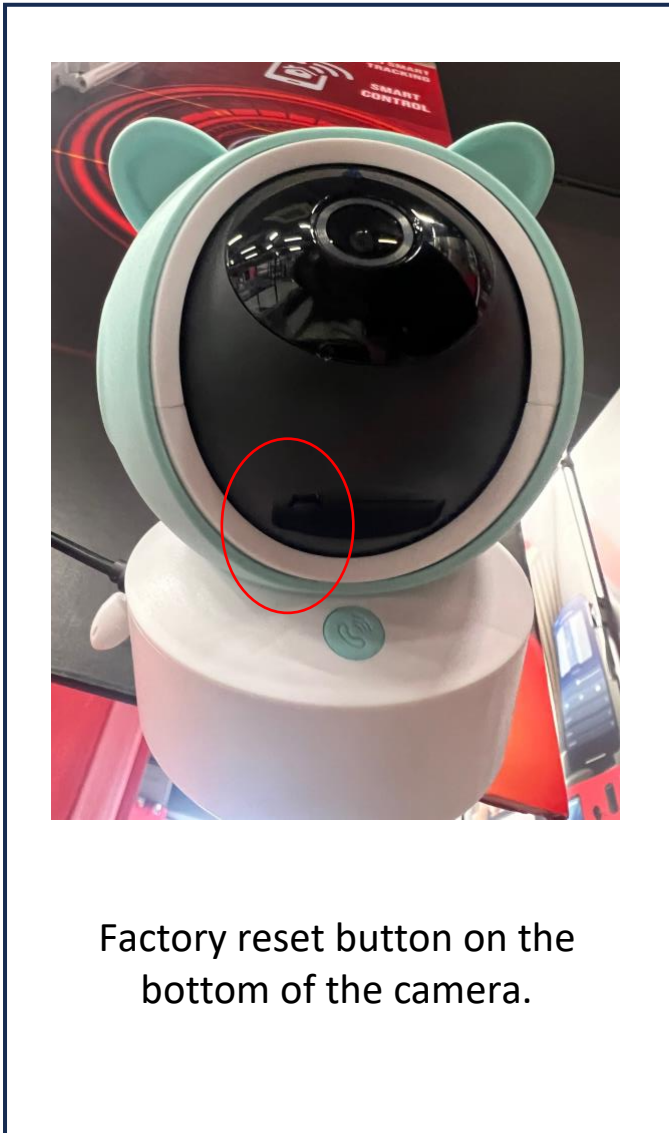

Power up camera.

Camera will start rotating.

Camera is in pairing mode.

If camera does not rotate, press the factory reset button.

Step 2

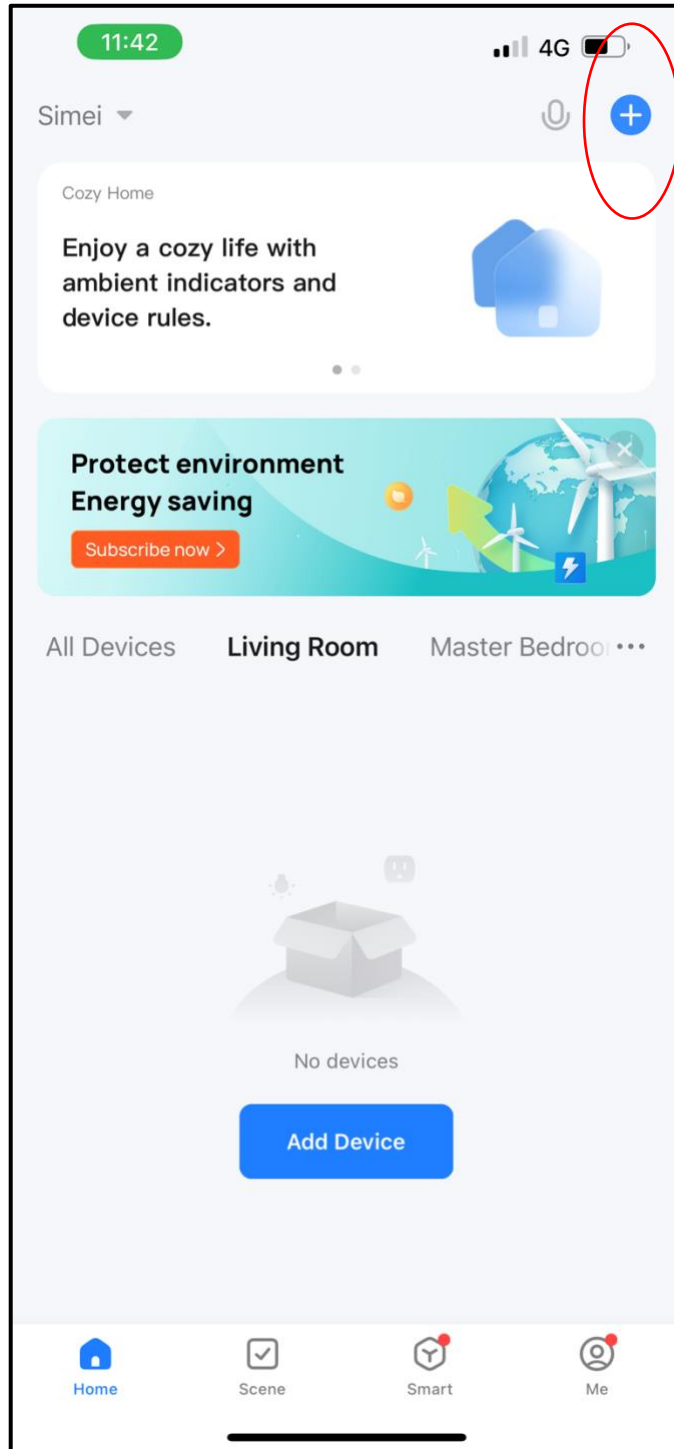

Step 3

Step 4

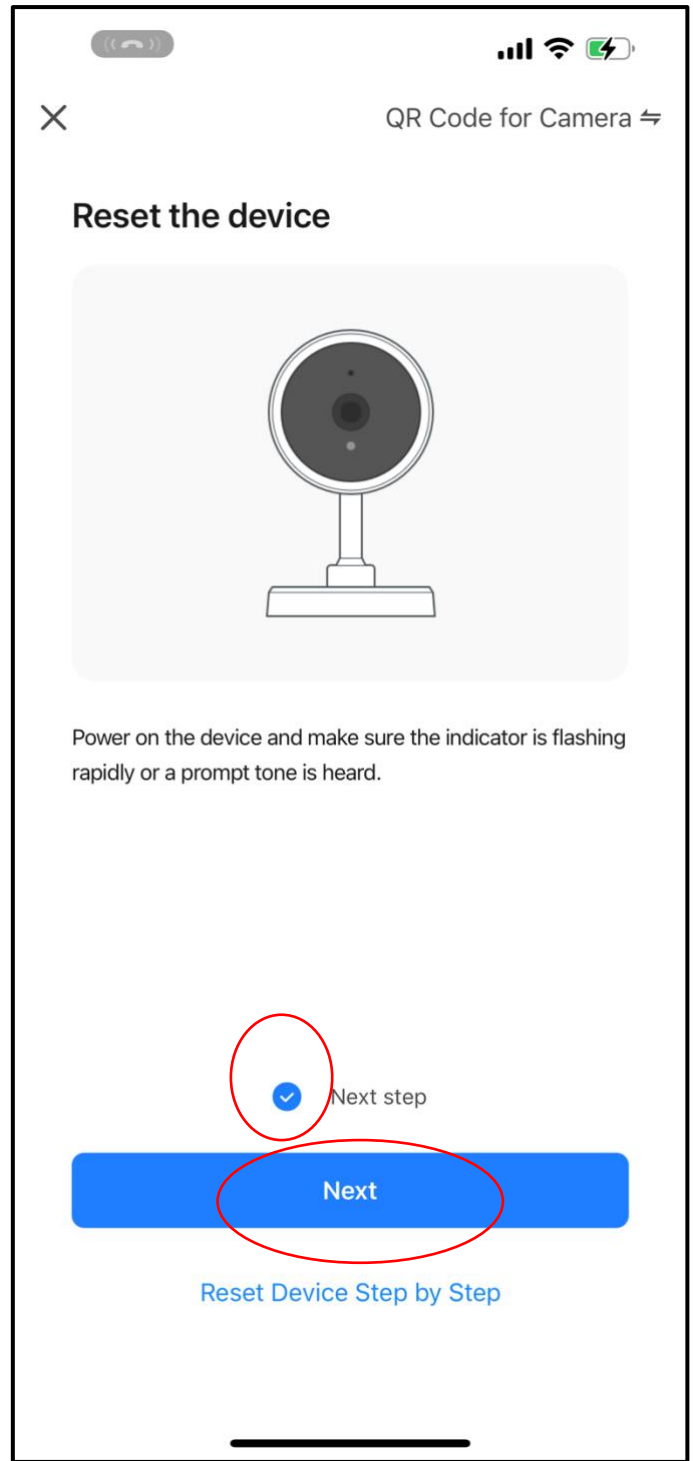
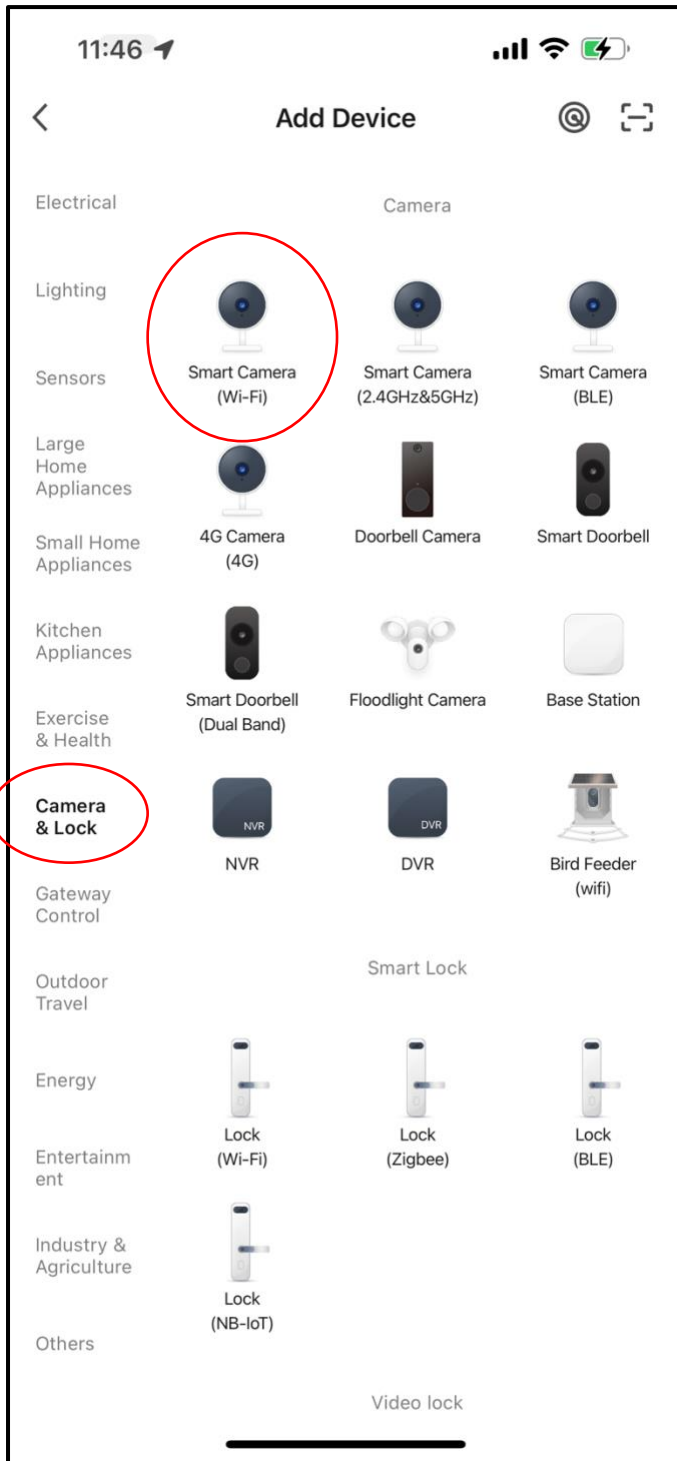

Select the correct device.

Check the box

Click "Next" to continue

Step 5

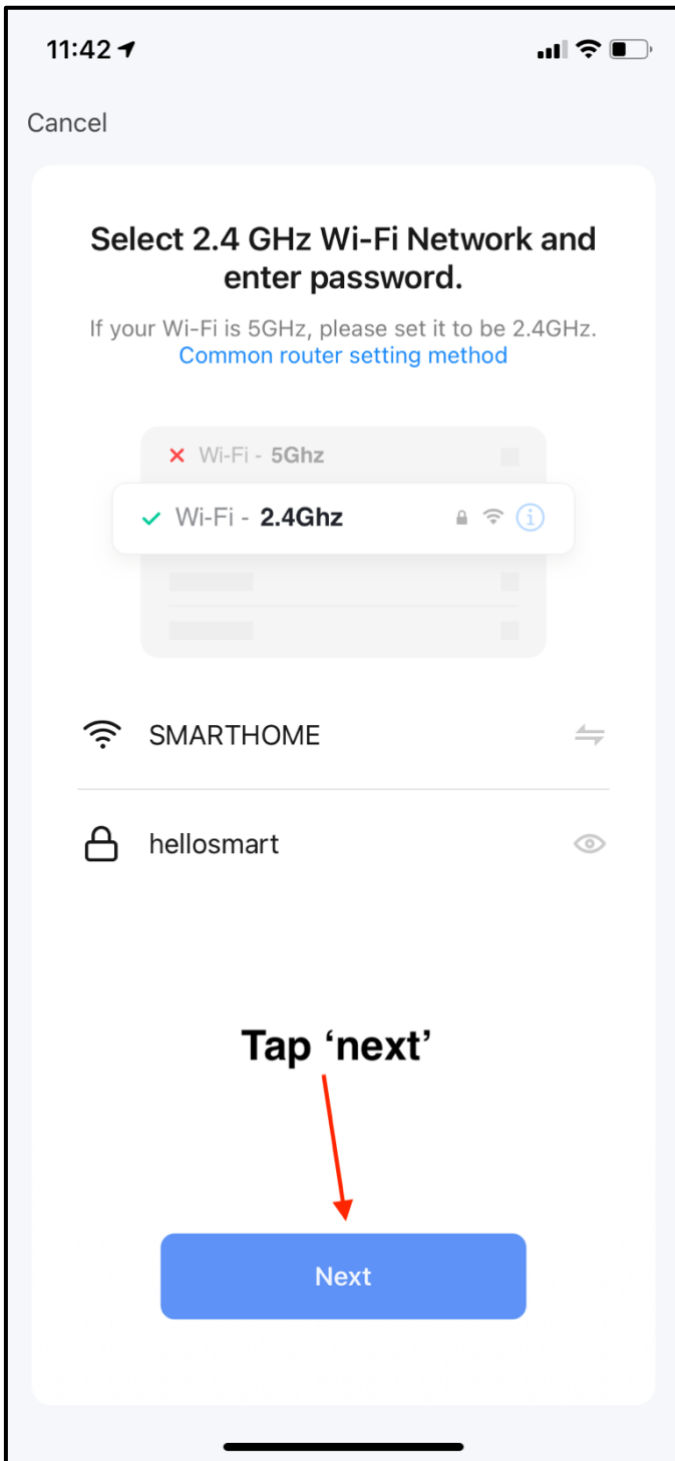

Choose 2.4G network and key in the correct password.

Step 6

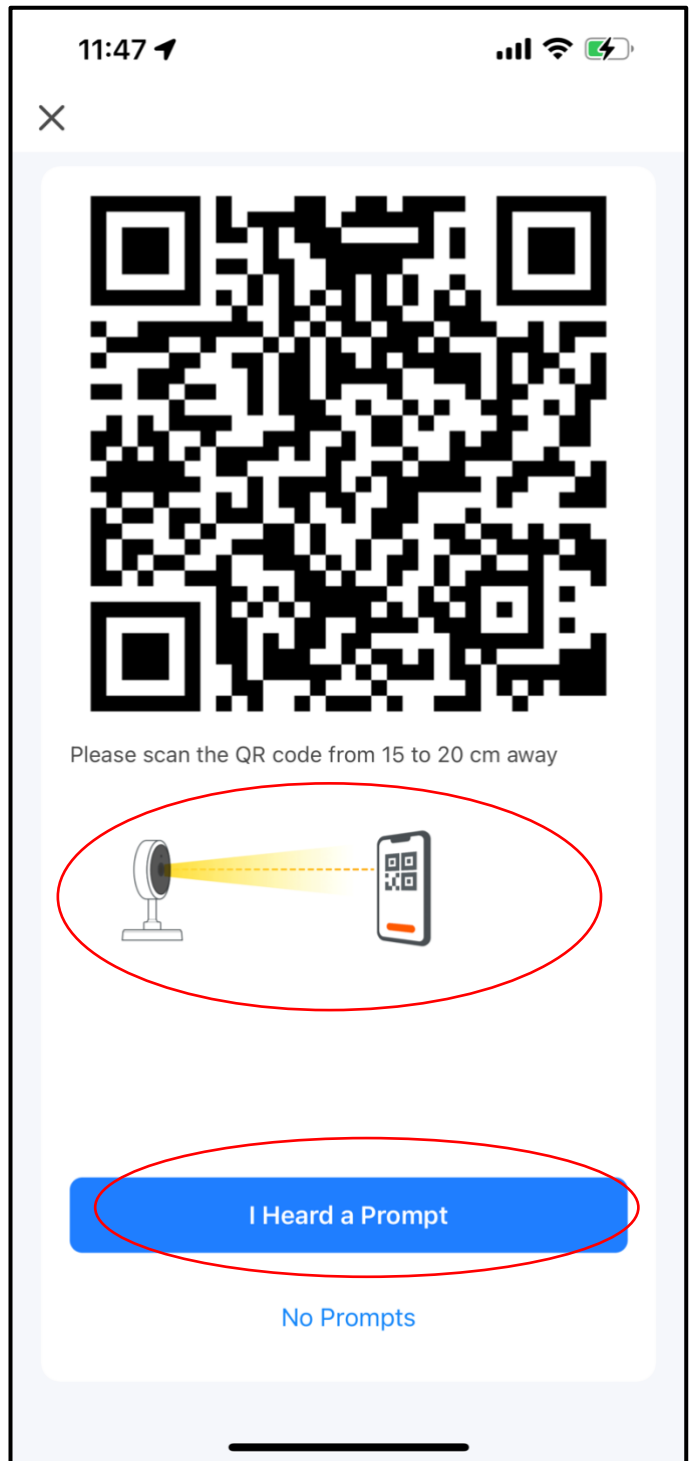

Scan the QR code on the app to the doorbell lens. Distance should be 15-20cm away.

After successful detection, tap "I Heard a Prompt"

Step 7

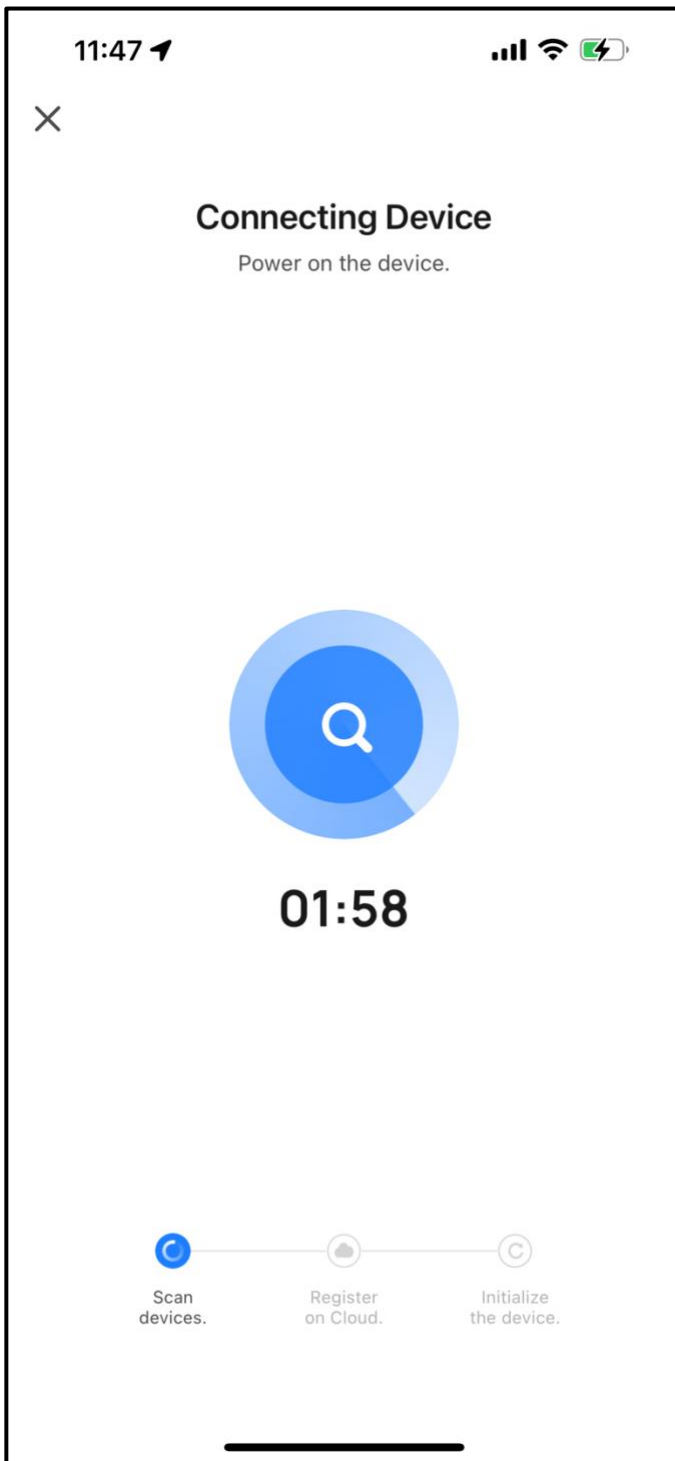

If pairing is not successful,
repeat Step 1 again.

The camera pairing process
will begin.